

DE BETERE METERS

LICHTER. STILLER. SLIMMER.



CATALOGUS

MASTER3PLUS

Geluidsarm binnenrioleringsysteem

PIPELIFE 

MASTER3PLUS BUIS GLAD

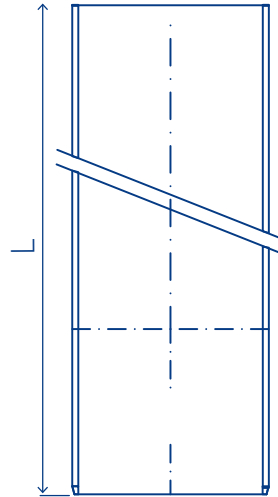

DN/OD	32	40	50	75	90	110	125	160
s1	1.8	1.8	2.0	2.4	2.9	3,4	3,9	4,9

L (mm)	Gewicht (kg/stuk)							
3000	0,59	0,74	1,04	1,92	2,78	4,27	5,26	8,52
5000	0,99	1,24	1,74	3,20	4,64	7,12	8,77	14,20

	CODE							
L (mm)	32	40	50	75	90	110	125	160
3000	1298622323	1298622403	1298622503	1298622753	1298622903	1298622113	1298622123	1298622163
5000	1298622325	1298622405	1298622505	1298622755	1298622905	1298622115	1298622125	1298622165

MASTER3PLUS BUIS GEMOFT

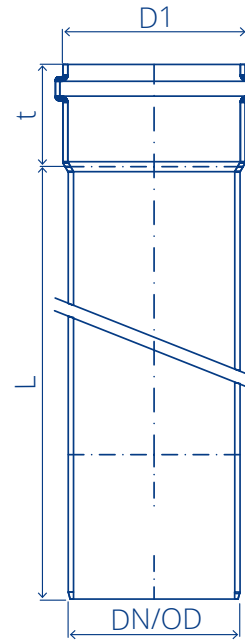

DN/OD	32	40	50	75	90	110
s1	1.8	1.8	2.0	2.4	2.9	3.4
d1	43.0	54.2	64.2	89.4	105.4	127.8
t	45	52	52	56	58	62

	CODE					
L (mm)	32	40	50	75	90	110
150	1195008850	1195008852	1195008854	-	1195008858	1195008856
250	1195008851	1195008853	1195008855	-	1195008859	1195008857
1000	1298632321	1298632401	1298632501	1298632751	1298632901	1298632111

MASTER3PLUS BOCHT

$\alpha = 15^\circ$ MS

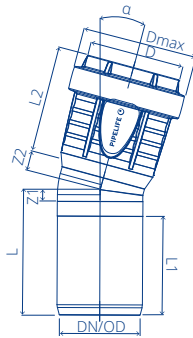

DN/OD	DN	D	DMAX	L1	L2	L	Z1	Z2	KG/stuk	↕	CODE
32	30	33.0	41.6	30	44.9	46	9	9	0.02	35	3496102859
40	40	41.1	53.3	46.5	50.6	59	5.5	9	0.04	20	3496103031
50	50	51.0	63.3	47	51.2	60	6	10	0.05	20	3496103033
75	70	76.1	89.1	53	54.8	68	8	12	0.10	20	3496103035
90	90	91.2	105.4	55	56.5	72	10	14	0.15	20	3496103037
110	100	111.3	127.0	59	60.6	76	10	15	0.24	20	3496103039
125	125	126.3	144.9	65	66.5	88	16	22	0.37	16	3496103118
160	150	161.5	183.4	74	75.5	95	14	21	0.65	12	3496103103

$\alpha = 30^\circ$ MS

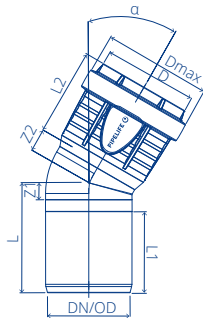

DN/OD	DN	D	DMAX	L1	L2	L	Z1	Z2	KG/stuk	↕	CODE
32	30	33.0	41.6	30	44.9	47	10	10	0.02	35	3496102860
40	40	41.1	53.3	46.5	50.6	62	8.5	12	0.04	20	3496103032
50	50	51.0	63.3	47	51.2	64	10	13	0.05	20	3496103034
75	70	76.1	89.1	53	54.8	74	14	18	0.11	20	3496103036
90	90	91.2	105.4	55	56.5	78	16	20	0.16	20	3496103038
110	100	111.3	127.0	59	60.6	84	18	23	0.27	20	3496102560
125	125	126.3	144.9	65	66.5	96	24	30	0.41	16	3496103119
160	150	161.5	183.4	74	75.5	106	25	32	0.72	6	3496103104

$\alpha = 45^\circ$ MS

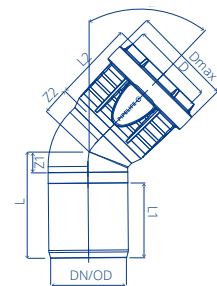

DN/OD	DN	D	DMAX	L1	L2	L	Z1	Z2	KG/stuk	↕	CODE
32	30	33.0	41.6	30	44.9	48	11	14	0.02	35	3496102861
40	40	41.1	53.3	46.5	50.6	65	11.5	15	0.04	20	3496102531
50	50	51.0	63.3	47	51.2	67	13	17	0.06	20	3496102494
75	70	76.1	89.1	53	54.8	79	19	23	0.12	20	3496102543
90	90	91.2	105.4	55	56.5	85	23	27	0.18	20	3496102552
110	100	111.3	127.0	59	60.6	92	26	31	0.29	20	3496102498
125	125	126.3	144.9	65	66.5	105	33	39	0.43	20	3496102568
160	150	161.5	183.4	69	75.5	114	38	45	0.80	6	3496102576

$\alpha = 67,5^\circ$ MS

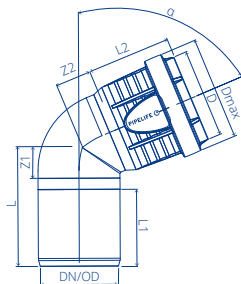

DN/OD	DN	D	DMAX	L1	L2	L	Z1	Z2	KG/stuk	↕	CODE
32	30	33.0	41.6	30	44.9	55	18	19	0.02	35	3496102862
40	40	41.1	53.3	46	50.6	70	17	20	0.05	20	3496103113
50	50	51.0	63.3	47	51.2	74	20	24	0.06	20	3496103114
75	70	76.1	89.1	53	54.8	89	29	33	0.13	20	3496103115
90	90	91.2	105.4	55	56.5	96	34	39	0.20	20	3496103116
110	100	111.3	127.0	59	60.6	106	40	45	0.32	20	3496103117

MASTER3PLUS BOCHT

$\alpha = 87,5^\circ$ MS

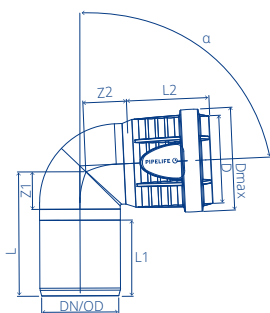

DN/OD	DN	D	DMAX	L1	L2	L	Z1	Z2	KG/stuk	↕	CODE
32	30	33.0	41.6	30	44.9	62	25	24	0.02	35	3496102863
40	40	41.1	53.3	46	50.6	76	23	26	0.05	20	3496102535
50	50	51.0	63.3	47	51.2	81	27	30	0.06	20	3496102496
75	70	76.1	89.1	53	54.8	101	41	45	0.14	20	3496102547
90	90	91.2	105.4	55	56.5	110	48	53	0.22	20	3496102556
110	100	111.3	127.0	59	60.6	124	58	63	0.36	20	3496102563
125	125	126.3	144.9	65	66.5	138	66	72	0.53	20	3496102571
160	150	161.5	183.4	74	75.5	162	81	88	0.97	4	3496102578

$\alpha = 45^\circ$ MM

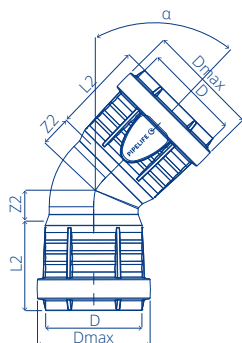

DN/OD	DN	D	DMAX	L2	Z2	KG/stuk	↕	CODE
40	40	41.1	53.3	50.6	15	0.05	20	3496102532
50	50	51.0	63.3	51.2	17	0.06	20	3496102537
75	70	76.1	89.1	54.8	23	0.13	20	3496102544
90	90	91.2	105.4	56.5	27	0.20	20	3496102553
110	100	111.3	127.0	60.6	31	0.32	24	3496102499
125	125	126.3	144.9	66.5	39	0.47	20	3496102569

$\alpha = 87,5^\circ$ MM

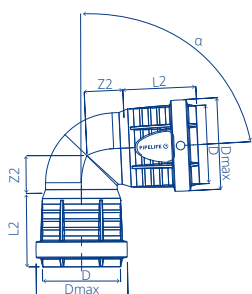

DN/OD	DN	D	DMAX	L2	Z2	KG/stuk	↕	CODE
40	40	41.1	53.3	50.6	26	0.05	20	3496102536
50	50	51.0	63.3	51.2	30	0.07	20	3496102539
75	70	76.1	89.1	54.8	45	0.15	20	3496102548
90	90	91.2	105.4	56.5	53	0.23	20	3496102557
110	100	111.3	127.0	60.6	63	0.37	20	3496102564
125	125	126.3	144.9	66.5	72	0.56	20	3496102572

Lange bocht $\alpha = 87,5^\circ$ MS

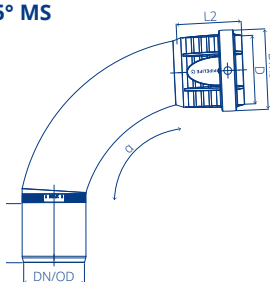

DN/OD	DN	D	DMAX	L1	L2	KG/stuk	↕	CODE
50	50	51.0	63.3	47	51.2	0.089	20	3496103144
75	70	76.1	89.1	53	54.8	0.169	20	3496103138
110	100	111.3	127.0	59	60.6	0.464	20	3496103140

Lange bocht $\alpha = 87,5^\circ$ MM

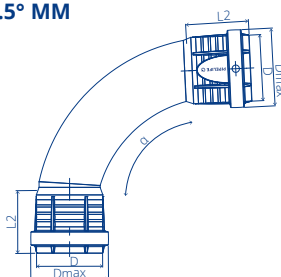

DN/OD	DN	D	DMAX	L2	KG/stuk	↕	CODE
50	50	51.0	63.3	51.2	0.1	20	3496103145
75	70	76.1	89.1	54.8	0.2	20	3496103139
110	100	111.3	127.0	60.6	0.5	20	3496103141

MASTER3PLUS T-STUK

$\alpha = 45^\circ$ MS

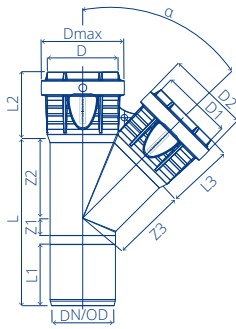

DN/OD	DN	D	D1	D2	DMAX	L1	L2	L3	L	Z1	Z2	Z3	KG/stuk	↕	CODE
32/32	30	33.0	33.0	41.6	41.6	16	44.9	44.9	47	10	40	35	0.03	20	3496102866
40/32	40	41.1	33.0	41.6	53.3	46	50.6	44.9	103	6	44	43	0.06	20	3496103123
40/40	40	41.1	41.1	53.3	53.3	46	50.6	50.6	114	12	49	49	0.07	20	3496102637
50/32	50	51.0	33.0	41.6	63.3	47	51.2	44.9	103	0	49	53	0.09	18	3496103125
50/40	50	51.0	41.1	53.3	63.3	46	51.2	50.6	114	6	55	57	0.09	20	3496103127
50/50	50	51.0	51.0	63.3	63.3	47	51.2	51.2	128	13	61	61	0.10	20	3496102647
75/50	70	76.1	51.0	63.3	89.1	54	54.8	51.2	135	-1	75	79	0.19	20	3496102651
75/75	70	76.1	76.1	89.1	89.1	53	54.8	54.8	170	19	91	91	0.23	20	3496102656
90/50	90	91.2	51.0	63.3	105.4	49	56.5	51.2	136	0	80	91	0.24	20	3496102661
90/75	90	91.2	76.1	89.1	105.4	56	56.5	54.8	172	11	98	102	0.30	20	3496102665
90/90	90	91.2	91.2	105.4	105.4	56	56.5	56.5	195	23	109	109	0.37	20	3496102669
110/50	100	111.3	51.0	63.3	127.0	59	60.6	51.2	142	-16	92	103	0.35	20	3496102512
110/75	100	111.3	76.1	89.1	127.0	59	60.6	54.8	175	1	108	118	0.43	16	3496102679
110/90	100	111.3	91.2	105.4	127.0	59	60.6	56.5	197	12	119	123	0.50	18	3496102684
110/110	100	111.3	111.3	127.0	127.0	59	60.6	60.6	225	26	133	133	0.59	16	3496102518
125/110	125	126.3	111.3	127.0	144.9	64	66.5	60.6	233	20	142	144	0.77	6	3496102692
125/125	125	126.3	126.3	144.9	144.9	64	66.5	66.5	254	31	152	152	0.91	5	3496102698
160/110	150	161.5	111.3	127.0	183.4	74	75.5	60.6	240	1	158	168	1.15	6	3496102704
160/125	150	161.5	126.3	144.9	183.4	74	75.5	66.5	263	13	169	177	1.31	6	3496102756
160/160	150	161.5	161.5	183.4	183.4	74	75.5	75.5	310	37	192	192	1.70	4	3496102709

$\alpha = 67.5^\circ$ MS

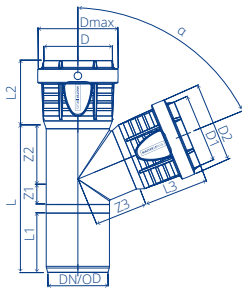

DN/OD	DN	D	D1	D2	DMAX	L1	L2	L3	L	Z1	Z2	Z3	KG/stuk	↕	CODE
50/50	50	51.0	51.0	63.3	63.3	47	51.2	51.2	117	20	43	43	0.10	20	3496103129
110/50	100	111.3	51.0	63.3	127.0	59	60.6	51.2	131	8	57	75	0.33	20	3496103130
110/75	100	111.3	76.1	89.1	127.0	59	60.6	54.8	158	21	71	80	0.39	20	3496103131
110/110	100	111.3	111.3	127.0	127.0	59	60.6	60.6	191	41	84	84	0.52	14	3496103132

$\alpha = 87.5^\circ$ MS

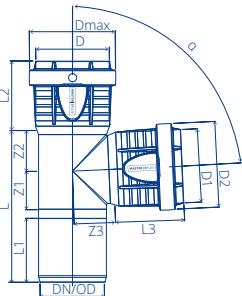

DN/OD	DN	D	D1	D2	DMAX	L1	L2	L3	L	Z1	Z2	Z3	KG/stuk	↕	CODE
32/32	30	33.0	33.0	41.6	41.6	16	44.9	44.9	52	15	30	35	0.04	20	3496102867
40/32	40	41.1	33.0	41.6	53.3	46	50.6	44.9	93	18	22	26	0.06	20	3496103124
40/40	40	41.1	41.1	53.3	53.3	46	50.6	50.6	101	23	25	25	0.07	20	3496102640
50/32	50	51.0	33.0	41.6	63.3	47	51.2	44.9	95	18	23	31	0.07	18	3496103126
50/40	50	51.0	41.1	53.3	63.3	46	51.2	50.6	102	23	26	30	0.08	20	3496103128
50/50	50	51.0	51.0	63.3	63.3	47	51.2	51.2	112	28	30	30	0.09	20	3496102509
75/50	70	76.1	51.0	63.3	89.1	54	54.8	51.2	121	28	32	43	0.16	20	3496102654
75/75	70	76.1	76.1	89.1	89.1	53	54.8	54.8	147	41	46	46	0.21	20	3496102659
90/50	90	91.2	51.0	63.3	105.4	56	56.5	51.2	122	26	33	51	0.22	20	3496102663
90/75	90	91.2	76.1	89.1	105.4	55	56.5	54.8	147	39	46	52	0.26	20	3496102667
90/90 *	90	91.2	91.2	105.4	105.4	55	56.5	56.5	187	81	44	79	0.36	15	3496102672
110/50	100	111.3	51.0	63.3	127.0	59	60.6	51.2	128	27	35	60	0.32	24	3496102515
110/75	100	111.3	76.1	89.1	127.0	59	60.6	54.8	151	39	46	62	0.38	20	3496102682
110/90 *	100	111.3	91.2	105.4	127.0	59	60.6	56.5	207	81	60	79	0.50	20	3496102686
110/110 *	100	111.3	111.3	127.0	127.0	59	60.6	60.6	207	81	60	79	0.54	14	3496102689
125/110	125	126.3	111.3	127.6	145.8	64.5	68.6	62.2	194	56.8	65.7	62.2	0.62	6	3496102695
125/125	125	126.3	126.3	144.9	144.9	65	66.5	66.5	225	73	80	80	0.77	6	3496102701
160/110	150	161.5	111.3	127.0	183.4	74	75.5	60.6	203	55	67	90	0.99	6	3496102706
160/160	150	161.5	161.5	183.4	183.4	74	75.5	75.5	253	80	92	92	1.34	6	3496102711

* Stroom-T

MASTER3PLUS T-STUK

$\alpha = 45^\circ$ MM

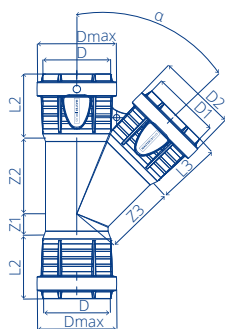

DN/OD	DN	D	D1	D2	DMAX	L2	L3	Z1	Z2	Z3	KG/stuk	↕	CODE
40/40	40	41.1	41.1	53.3	53.3	50.6	50.6	15	49	49	0.08	20	3496102638
50/50	50	51.0	51.0	63.3	63.3	51.2	51.2	61	61	61	0.11	20	3496102648
75/50	70	76.1	51.0	63.3	89.1	54.8	51.2	11	77	80	0.20	20	3496102652
75/75	70	76.1	76.1	89.1	89.1	54.8	54.8	22	91	91	0.24	20	3496102657
90/90	90	91.2	91.2	105.4	105.4	56.5	56.5	27	109	109	0.38	20	3496102670
110/50	100	111.3	51.0	63.3	127.0	60.6	51.2	-11	92	103	0.37	20	3496102513
110/110	100	111.3	111.3	127.0	127.0	60.6	60.6	31	133	133	0.62	16	3496102519
125/110	125	126.3	111.3	127.0	144.9	66.5	60.6	26	142	144	0.80	6	3496102693
125/125	125	126.3	126.3	144.9	144.9	66.5	66.5	37	152	152	0.95	5	3496102699

$\alpha = 87.5^\circ$ MM

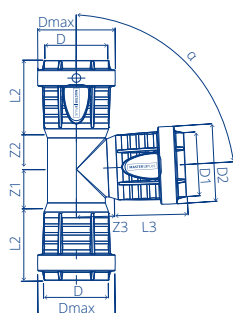

DN/OD	DN	D	D1	D2	DMAX	L2	L3	Z1	Z2	Z3	KG/stuk	↕	CODE
40/40	40	41.1	41.1	53.3	53.3	50.6	50.6	26	25	25	0.07	20	3496102641
50/50	50	51.0	51.0	63.3	63.3	51.2	51.2	32	30	30	0.10	20	3496102510
75/50	70	76.1	51.0	63.3	89.1	54.8	51.2	32	32	43	0.16	20	3496102655
75/75	70	76.1	76.1	89.1	89.1	54.8	54.8	45	46	46	0.21	20	3496102757
90/90	90	91.2	91.2	105.4	105.4	56.5	56.5	50	44	79	0.33	20	3496102674
110/50	100	111.3	51.0	63.3	127.0	60.6	51.2	32	35	60	0.34	24	3496102516
110/110 *	100	111.3	111.3	127.0	127.0	60.6	60.6	86	60	79	0.56	15	3496102690
125/110	125	126.3	111.3	127.0	144.9	66.5	60.6	63	66	72	0.66	6	3496102696
125/125	125	126.3	126.3	144.9	144.9	66.5	66.5	79	80	80	0.81	6	3496102702

* Stroom-T

Hoek T-stuk $\alpha = 87.5^\circ$ MS

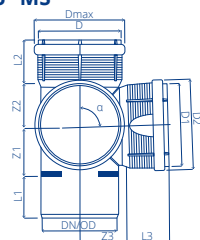

DN/OD	DN	D	D1	D2	DMAX	L1	L2	L3	Z1	Z2	Z3	KG/stuk	↕	CODE
110/110	100	111.3	111.3	127	127	61	60.6	60.6	59	64	64	0.63	12	3496103108

Dubbel T-stuk $\alpha = 87.5^\circ$ MS

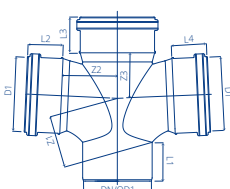

DN/OD	DN	DN/OD1	D1	L1	L2	L3	L4	Z1	Z2	Z3	KG/stuk	↕	CODE
110/50	100	110	50	60	44	54.0	44.0	25	63	42.5	0.39	5	1533000628
110/110*	100	110	110	64	66	59.0	59.0	69	78	58	0.81	5	1533000629

* Stroom-T

MASTER3PLUS LANGE REDUCTIE

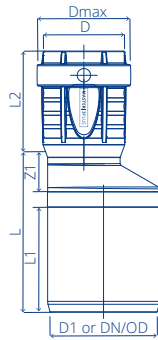

DN/OD	DN	D	D1	DMAX	L1	L2	L	Z1	KG/stuk	↕	CODE
40/32	40	33.0	41.6	41.1	47	50.6	66	12	0.03	20	3496102588
50/32	50	33.0	41.6	51	47	51.2	72	18	0.04	20	3496103120
50/40	50	41.1	53.3	51	47	51.2	66	12	0.04	20	3496102590
75/40	70	41.1	53.3	76.1	53	54.8	87	27	0.08	20	3496102593
75/50	70	51.0	63.3	76.1	54	54.8	81	20	0.08	20	3496102595
90/50	90	51.0	63.3	91.15	55	56.5	91	29	0.11	18	3496102597
90/75	90	76.1	89.1	91.15	55	56.5	78	16	0.12	24	3496102599
110/50	100	51.0	63.3	111.3	59	60.6	109	43	0.17	20	3496102602
110/75	100	76.1	89.1	111.3	59	60.6	93	27	0.19	20	3496102604
110/90	100	91.2	105.4	111.3	59	60.6	85	19	0.19	12	3496102608
125/110	125	111.3	127.0	126.3	64	66.5	89	18	0.28	12	3496102606
160/110	150	111.3	127.0	161.5	74	75.5	120	39	0.47	20	3496102610
160/125	150	126.3	144.9	161.5	74	75.5	111	30	0.51	14	3496102612

MASTER3PLUS UITZETMOF

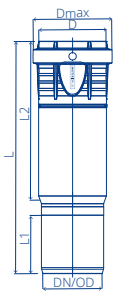

DN/OD	DN	D	DMAX	L1	L	L2	KG/stuk	↕	CODE
40	40	41.1	53.3	46.0	177	118	0.06	20	3496102619
50	50	51.0	63.3	47.0	187	128	0.08	20	3496102621
75	70	76.1	89.1	53.5	205	138	0.16	8	3496102623
90	90	91.2	105.4	55.0	224	154	0.25	12	3496102625
110	100	111.3	127.0	59.0	244	170	0.37	15	3496102503

MASTER3PLUS STEEKMOF/OVERSCHUIFMOF

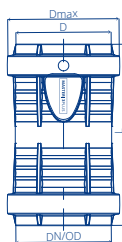

DN/OD	DN	D	DMAX	L	Z1	KG/stuk	↕	CODE
32*	30	33.0	41.6	100	0.02	30	30	3496102865
40	40	41.1	53.3	102	0.04	20	20	3496102613
50	50	51.0	63.3	103	0.05	20	20	3496102500
75	70	76.1	89.1	116	0.10	16	16	3496102614
90	90	91.2	105.4	120	0.15	20	20	3496102615
110	100	111.3	127.0	129	0.23	20	20	3496102501
125	125	126.3	144.9	140	0.33	8	8	3496102616
160	150	161.5	183.4	159	0.60	12	12	3496102617

De unieke dubbele mof is een steek- én schuifmof in één, waardoor je altijd over een passende mof beschikt.

(*) Enkel overschuifmof

MASTER3PLUS KORTE REDUCTIE

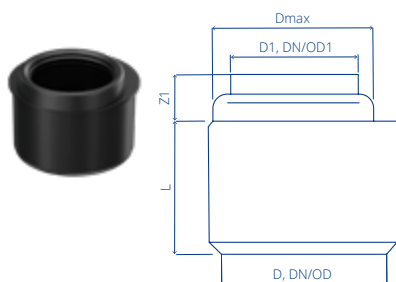

DN/OD	DN	DN/OD1	D	D1	DMAX	L	Z1	KG/stuk	↳	CODE
40/32	40	32	41.1	33.0	53.3	43	15	0.04	60	70021408
50/32	50	32	51.0	33.0	63.3	47	16	0.05	60	70024364
50/40	50	40	51.0	41.1	63.3	47	16	0.05	60	70007119
75/40	75	40	75	40	58.6	53	13.9	0.08	25	70013294
75/50	70	50	76.1	51.0	89.1	54	17	0.08	32	70007120
90/50	90	50	91.2	51.0	105.4	66	17	0.11	50	1297070081
90/75	90	75	91.2	76.1	105.4	61	17	0.12	15	2196180587
110/40	100	40	111.3	41.1	127.0	66	18	0.15	25	70007066
110/50	100	50	111.3	51.0	127.0	66	18	0.16	30	70007121
110/75	100	75	111.3	76.1	127.0	66	19	0.16	20	70007774
110/90	100	90	111.3	91.2	127.0	66	19	0.17	20	2196180591

MASTER3PLUS VERLOOPRING VOOR DUNWANDIGE BUIS



DN/OD	KG/stuk	↳	CODE
50/40	0,02	60	1195008827
90/50	0,04	30	1195008829
110/40	0,05	35	1195008831
110/50	0,05	35	1195008833
110/75	0,06	35	1195008835
110/90	0,06	35	1195008837

MASTER3PLUS VERLOOPRING VOOR DIKWANDIGE BUIS

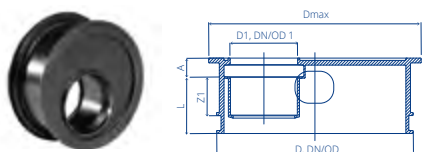

DN/OD	DN	DN/OD1	D	D1	DMAX	KG/stuk	↳	CODE
50/40	50	40	51.0	41.1	63.3	0,02	60	1195008828
90/50	90	50	91.2	51.0	105.4	0,04	30	1195008830
110/40	100	40	111.3	41.1	127.0	0,05	35	1195008832
110/50	100	50	111.3	51.0	127.0	0,05	35	1195008834
110/75	100	75	111.3	76.1	127.0	0,06	35	1195008836
110/90	100	90	111.3	91.2	127.0	0,06	15	1195008838

MASTER3PLUS STOP

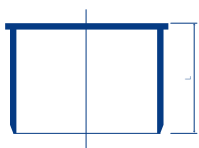

DN/OD	I	KG/stuk	↕	CODE
32	33	0,008	35	3496102864
40	39	0,010	40	3496102763
50	39	0,014	40	3496102764
75	39	0,027	40	3496102765
90	42	0,041	20	1297070103
110	46	0,068	20	3496102584
125	50	0,089	14	3496102766
160	58	0,174	16	3496102767

MASTER3PLUS RECHT AANSLUITSTUK VOOR SIFON

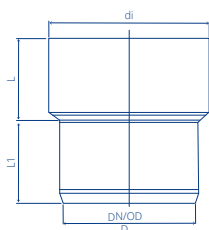

DN/OD	DN	D	DI	L1	L	KG/stuk	↕	CODE
32	30	33	53.7	31	32	0.03	20	3496102758
40	40	41.1	53.7	32	30	0.02	20	3496102759
50	50	51	53.7	29	31	0.03	20	3496102760

MASTER3PLUS AANSLUITBOCHT 90° VOOR SIFON

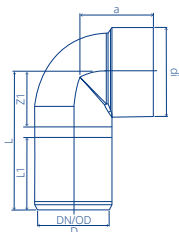

DN/OD	DN	D	DI	L	Z1	(A)/SIPHON	L1	KG/stuk	↕	CODE
32	30	33.0	53.7	47	25	54	15	0.03	20	3496103112
40	40	41.1	53.7	88	35	57	46	0.05	20	3496102524
50	50	51.0	53.7	90	35	52	48	0.05	20	3496102527

MASTER3PLUS ONTSTOPPINGSSTUK 90° MS

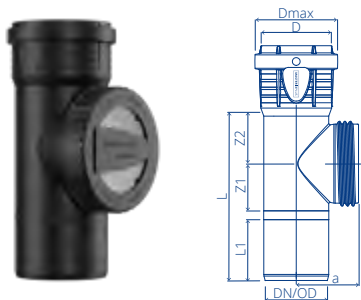

DN/OD	DN	D	DMAX	L1	L	Z1	Z2	KG/stuk	↕	CODE
50	50	51.0	63.3	47	130	76	36	0.09	25	3496103121
75	70	76.1	89.1	53	142	82	40	0.16	20	3496103105
90	90	91.2	105.4	55	189	127	62	0.28	12	3496102629
110	100	111.3	127.0	59	194	128	62	0.41	20	3496102631
125	125	126.3	144.9	65	225	154	74	0.63	8	3496103122
160	150	161.5	183.4	74	253	172	80	1.08	6	3496103106

MASTER3PLUS VENTILATIESTUK

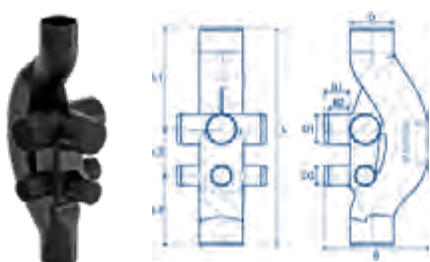

DN/OD	D	D1	D2	B	B1	B2	L	L1	L2	L3	KG/stuk	↕	CODE
110	110	110	75	330	80	65	736	313	170	253	0.40	12	1533000626
160	160	110	75	378	80	65	793	370	170	253	1.30	8	1533000627

MASTER3PLUS AKOESTISCHE BOCHT

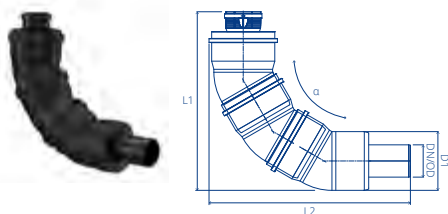

DN/OD	L1	L2	D1	R	CODE
110	608	686	200	400	Op aanvraag

GELUIDDEPENDE BEVESTIGINGSBEUGEL



DN/OD	KG/stuk	↕	CODE
32	0.10	100	1195008765
40	0.11	100	1195008766
50	0.12	50	1195008767
75	0.25	50	1195008768
90	0.27	50	1195008769
110	0.31	50	1195008770
125	0.35	50	1195008771
160	0.42	50	1195008772



TECHNISCHE EIGENSCHAPPEN

TECHNISCHE EIGENSCHAPPEN

Toepassingsklasse

De grondstof van Master3Plus is halogeenvrij, mineraal versterkt polypropyleen copolymeer. Ontwikkeld om te kunnen voldoen aan de hedendaagse uitdagingen. Van residentiële, commerciële en industriële bouwprojecten.

Materiaal

Buis: PP-CO/PP-MV/PP-CO

Hulpstuk: PP-CO-MV

Afdichting: EPDM

Temperatuurbestendigheid

Continue belasting 60°C, max. 95°C

Brandclassificatie

B2 volgens DIN 4102

Chemische weerstand

Zuren en basen variërend van pH 2 tot pH 12

Fabrieksnormen

Buizen en hulpstukken zijn getest volgens EN 1451-1.

Diameter bereik

32 - 160 mm

Buislengtes

Gemofte buislengtes: 150 mm, 250 mm en 1000 mm
Gladde buislengtes: 3000 mm en 5000 mm

Uv-resistentie

Hoge UV-bestendigheid - buitenopslag tot 2 jaar bij correcte opslag.
(zie Master3Plus installatierichtlijnen).

Akoestiek

<10 dB(A), getest volgens DIN EN 14366:2005
(buizen) en DIN 4109 en VDI 4100
(bevestigingsbeugels)

Levensduur

Meer dan 50 jaar

Duurzaamheid

Remontabel systeem, 100% recyclebaar

ONTDEK HET VOLLEDIGE ASSORTIMENT BINNEN-RIOLERINGSYSTEMEN

Bij Pipelife vind je diverse programma's PVC en PP buizen en hulpstukken om vuil- en hemelwater in en rondom huizen, woongebouwen en bedrijfspanden af te voeren. Naast Master3Plus zijn er de programma's Polisan (zowel in PVC- als PP-uitvoering) en Topfit (PP). Alle producten kenmerken zich door betrouwbaarheid, veiligheid, gemak en installatiesnelheid. Voor elk project en voor iedere vakman is er altijd een slim en compleet assortiment beschikbaar.

Ontdek het volledige assortiment op pipelife.nl/binnenriolering



Disclaimer

Deze brochure is met de grootst mogelijke zorg samengesteld. Er kunnen echter geen rechten aan worden ontleend. Drukfouten voorbehouden. Niets uit deze brochure mag worden veeveelvoudigd en/of openbaar worden gemaakt zonder voorafgaande schriftelijke toestemming van Pipelife Nederland.